



TRX  
RESIDENCES

My Home

Designed with care.  
Crafted for you.

Our vision is to create the best places. Every project is designed from the inside out, anticipating your every need and ensuring they are well met, with each component designed to captivate and delight.

TRX Residences continues this ethos; crafted with care so that your heart feels at home.

**CREATING THE BEST PLACES**

- Experts in urban regeneration
- Inspiring and enriching lives
- Legacy of safety, innovation and sustainability



Life at the centre.

TRX Residences is part of the world's most liveable financial district; a next-generation, integrated master-planned development intuitively designed by global powerhouses. Live large in true convenience, revel in unrivalled connectivity, and celebrate lush biophilic relationships within a future-focused environment that is safe and secure.

**LIVE IN KL'S NEW CENTRE OF GRAVITY**

- Freehold
- Hyper-connected
- The Exchange TRX Retail Centre
- 10-acre Activated City Park
- Luxury Lifestyle Hotel
- Campus-style Office

Stepping into your home begins in the lobby.

In TRX Residences, the concierge greets you with a warm welcome each time you return because home is a place where there are no strangers. Grand entrances, just off the main boulevards, are designed with carefully curated furnishings and fittings to create a warm ambiance for your guests.



The Lobby

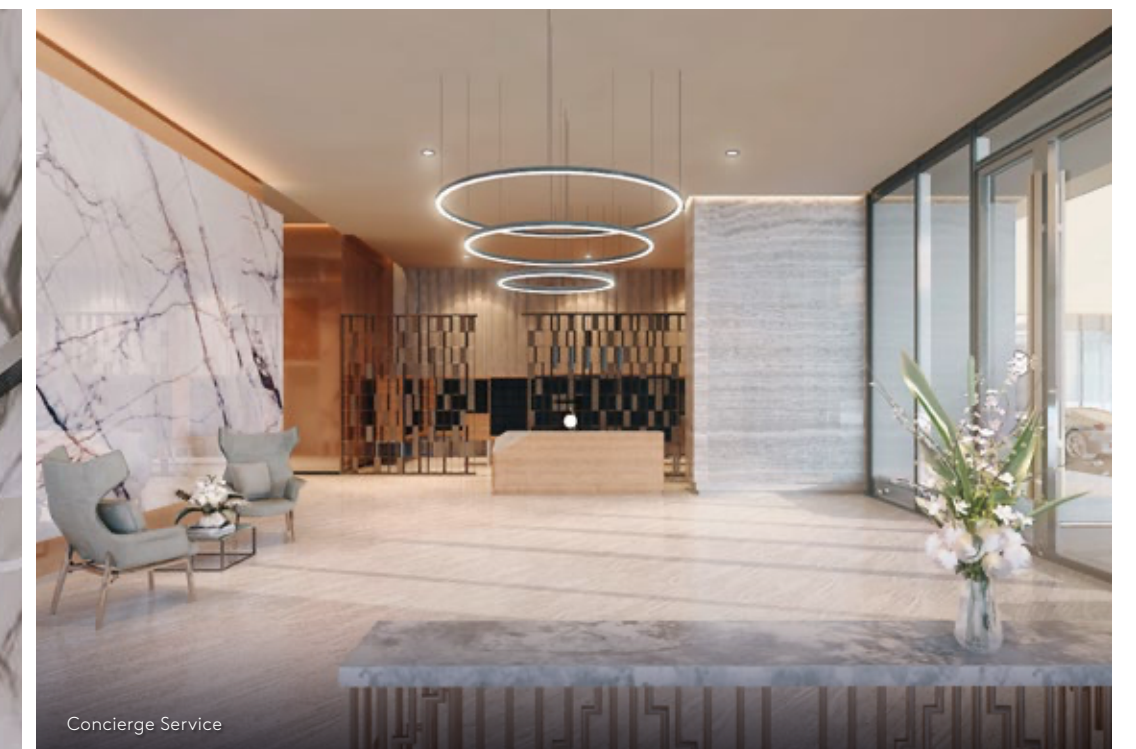

Concierge Service



The Jewel - Arrival Statement

**A HOST OF RESIDENT-CENTRED FEATURES**

- Slip-resistant flooring
- Universal design ensures accessibility regardless of age or ability
- Concierge service

Every inch has a purpose,  
every space precious.

We take the aesthetics of good design further,  
ingeniously blending it with functionality to deliver  
optimal space in the right places. Your global lifestyle  
is well accommodated with accurate design and  
flexible applications.

**STORAGE IS PRECIOUS**

- Flexible design options\*
- Storage lockers at car park levels\*
- Wardrobe and kitchen cabinets  
are provided

The best of both worlds,  
where urbanity intersects  
with nature.



The bedrooms in TRX Residences are efficiently designed for optimal comfort and complemented with bathrooms fully-fitted by Kohler. Be inspired by the sparkling KL city skyline view or soothing greenery of the activated city park.

A social hub; because reunions are everyday affairs.

Our culture cherishes eating together because it nurtures togetherness. We've designed the kitchen as the landing area for each unit, to encourage everyday gatherings and functions. All kitchens are fitted with imported Italian built-in cabinets. Cook at home or order-in from the variety of great F&B options at The Exchange TRX retail centre.

- Fully-fitted kitchen\*
- Colour scheme selection in the units\*\*
- Double-glazed curtain wall with low E glass for thermal and auditory comfort

\* Washing machine is not included

\*\*Subject to availability

3-Bedroom - Living, Dining Room

City living needs  
living gardens to  
retreat to.

The conservatory is designed as a lush and green oasis for you to take refuge and re-energise from the demands of today's dynamic work environment. Plants are carefully curated by a botanist and horticulturist to enhance a sense of biophilia and calm.

**GARDENS DESIGNED TO CLEAR  
THE MIND**

- Gardening shed for the avid gardener
- Urban farming options
- Pocket gardens every 5 floors
- Direct connection to the 10-acre activated city park on Level 8



Conservatory

90,000 sq. ft. of facilities,  
just a lift ride away.

That's almost the size of two football fields. The facilities are spread over different floors and cover leisure, health, well-being, entertainment and more. All conceptualised and delivered to accommodate your urban lifestyle, where everything is within quick and easy reach. Celebrate life with confidence, in well-designed and safe spaces.



Sky Deck - Level 29



BBQ Area - Level 8



Lap Pool - Level 29

FACILITIES

LEVEL 8

- Gym
- Swimming Pool
- Kids Pool
- Pool Deck & Lounge
- Steam Room
- Function Terrace
- BBQ Area & Herb Garden
- Private Living Room
- Multi-Purpose Hall
- Kids Indoor & Outdoor Play Area
- Jacuzzi

LEVEL 29

- Plunge Pools
- Lap Pool
- Yoga Deck
- The Social Bar
- Residents' Lounge
- Gourmet Dining Rooms
- Conservatory
- Outdoor Workout Deck
- Outdoor Lounge 1 & 2
- Fitness Studio
- Viewing Deck
- Lounger Deck
- Stretch & Warm Down Garden
- Outdoor Dining

LEVEL 30

- Gardening Workshop
- Games Room
- Media Room
- Co-working Space



The Social Bar - Level 29

## Designed for casual collisions, and purposeful relationships.

Communities are built when there are deliberate spaces to cultivate relationships. We have articulated multiple opportunities to harness the benefits of this urban village, enhancing your living experience at TRX Residences. The choice is yours: keep meetings casual or form firm friendships.

### FOSTERING FAMILY & COMMUNITY TIES

- Kids Indoor & Outdoor Play Area
- BBQ Area & Herb Garden
- The Social Bar
- Residents' Lounge & Co-working Space
- Gourmet Dining Rooms

Stylish venues for every occasion,  
right where you live.



Wouldn't it be lovely to entertain friends and family close to home? TRX Residences boasts various spaces for you to do just that. There are spaces that function as an extension of your home to host intimate dinners, casual social gatherings, grand affairs, or just about any celebration.

- Multi-Purpose Hall
- BBQ Area & Herb Garden
- Private Living Room
- Gourmet Dining Rooms
- Outdoor Dining
- Plunge Pools



Gourmet Dining Rooms - Level 29

# Technology is not extraordinary, people are.

People and communities are the pulse of every development. Drawing from our extensive worldwide successes, we're constantly improving our approach to facilitate a sense of belonging. As a resident in TRX Residences, we will develop platforms for you to engage with your neighbours and share activities, services, alerts and other useful information. It's a thoughtful way to nurture a community because people make places come alive.



- Community Manager, to keep the community at TRX Residences engaged
- Residents' network – borrowing tools, sharing activities & interests
- Precinct updates – latest updates in The Exchange TRX
- Emergency contacts
- Car sharing\* enables easy mobility without the burden of car-ownership; a fleet of cars is available to drive via a pay-by-use system

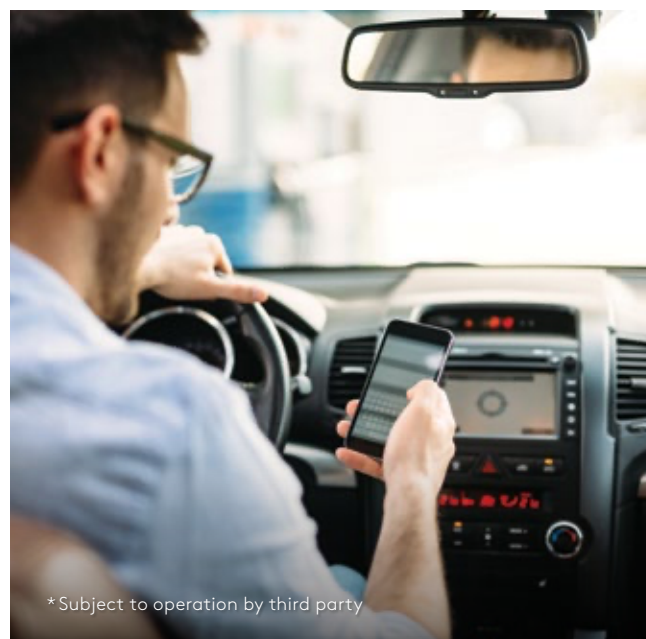

\* Subject to operation by third party



# Value-crafted for today, seeded for the future.

The philosophy that anchors all our projects is our safety and sustainability framework. Spaces and places are being shaped by the global forces of climate change, rapid urbanisation, resource stress and more.

Global integrated living standards have been incorporated within and around TRX Residences to protect your legacy into the future.

The result is an address of choice and international importance that personifies healthy living spaces and environmentally accountable living practices.



## HEALTHY



- Active lifestyle-enabled
- Age appropriate facilities
- Direct link to 10-acre activated city park
- Natural and mechanical ventilation in every bedroom for clean air
- VOC\*\* -free interior materials

\* Volatile Organic Compound

## GREEN



Low energy living; Solar panels



Pocket gardens every 5 floors



Use of environmentally friendly materials from sustainable sources



Recycled water



Rainwater harvesting

## CONNECTED



- Quick access to comprehensive lifestyle needs and amenities
- Direct link to a purpose-built, and the only MRT interchange station
- Direct link to SMART Tunnel and major highways
- High-speed internet connectivity
- Dedicated pedestrian walkways to city landmarks

## COMMUNITY+



- Community+ is a customised app that revolves around community needs. It includes a library of services, transportation updates, forums and more, all supported by a Community Manager to ensure engagement.

## SAFE & SOUND

Your safety is our priority. TRX Residences offers international standards of active and passive safety for your ultimate peace of mind.

- Comprehensive sprinkler system to ensure fire safety
- Slip-resistant floors in common areas
- Hedges around the pool to keep children safe
- Spotlights define navigation paths and frame key zones
- Height-appropriate amenities and protection to prevent falls
- Angled balustrades to avoid drops
- Relentless focus on construction safety ensures better build quality

## SMART LIVING

- Future-focused to offer you nimble and unencumbered smart living via car sharing, furnishing packages and lease management service\*

\* Subject to operation by third party

# The Lendlease story.



Barangaroo South, Sydney

Our vision is

to create the  
best places.

Lendlease is an international property and infrastructure group with operations in the Americas, Asia, Australia, and Europe. We have over 60 years of experience in shaping city skylines, building iconic structures and setting new benchmarks in urban living across the globe.

As experts in urban regeneration, we work with governments and communities to transform entire neighbourhoods, creating places that leave lasting legacies for future generations. We have proudly delivered approximately 100,000 high calibre residences, crafted landed communities, apartments, military housing and senior living homes.

The Lendlease brand represents trust, excellence, and integrity. Some of the best places we've created and developed include Barangaroo South in Sydney, Elephant & Castle in London, Petronas Twin Towers in Kuala Lumpur, and Paya Lebar Quarter in Singapore, to name just a few.

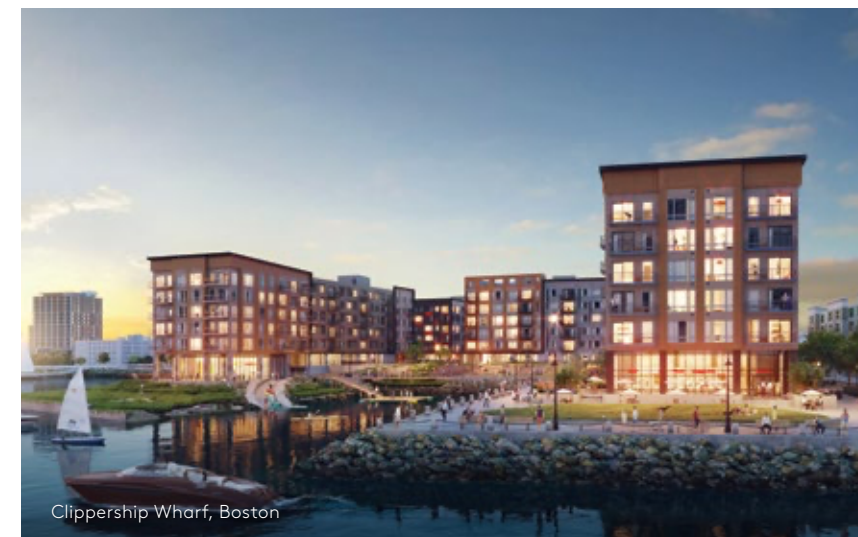

Clippership Wharf, Boston



Island Palm Communities, Hawaii



Elephant & Castle, London



Walk close, but travel far

SALES OFFICE  
TRX Residences Discovery and Experience Gallery  
Regal House, 1 Jalan U-thant (Off Jalan Tun Razak)  
55000 Kuala Lumpur, Malaysia

+603 2385 9800  
[www.trxresidences.my](http://www.trxresidences.my)

A Joint Venture Between



DEVELOPER: LQ Residential 1 Sdn Bhd (1135543-P) • ADDRESS: Level 8, Menara Public Gold (formerly known as Menara JCorp), 249, Jalan Tun Razak, 50400 Kuala Lumpur • DEVELOPER'S LICENSE: 19603/02-2025/0138 (R) • VALIDITY PERIOD: 15/02/2022 – 14/02/2025 • ADVERTISING & SALES PERMIT: 19603-1/02-2023/0021 (R)-(S) • VALIDITY PERIOD: 15/02/2022 – 14/02/2023 • APPROVING AUTHORITY: Dewan Bandaraya Kuala Lumpur • BUILDING PLAN NO: BP T4 OSC 2017 1462 • LAND TENURE: Freehold • EXPECTED COMPLETION: March 2024 • LAND ENCUMBRANCES: NIL • TYPE OF PROPERTY: Service Apartment Tower A & Tower B • DEVELOPMENT NAME: TRX Residences • CAR PARK: 1,020 • BUILT-UP: Type 1: 474 sq. ft., Type 1A: 538 sq. ft., Type 2: 624 sq. ft., Type 2A: 700 sq. ft., Type 2B: 721 sq. ft., Type 3: 850 sq. ft., Type 3A: 1,076 sq. ft., Type 4: 1,184 sq. ft., Type 5: 1,216 sq. ft., Type 5A: 1,259 sq. ft., Type 5B: 1,345 sq. ft., Type 6: 1,625 sq. ft., Type 6A: 1,636 sq. ft., Villa: Type A1: 2,422+851 sq. ft., Type B1: 3,165+689 sq. ft., Type C: 2,239+452 sq. ft., Type A2: 2,400+549 sq. ft., Type A3: 2,497+1,109 sq. ft., Type B2: 3,197 sq. ft. • TOTAL UNITS: 896 • AVAILABLE UNITS: Tower A: 171 units, Tower B: 381 units • SELLING PRICE: RM1,067,000 (Min) – RM6,351,000 (Max) • BUMIPUTERA DISCOUNT: 5%. All renderings contained in this brochure are artist's impression only.

IKLAN INI TELAH DILULUSKAN OLEH JABATAN PERUMAHAN NEGARA